

POWERMADD® Plastic Mini-Ski

Mounting Instructions for Ski Doo Mini Z Saddle Kit Part No. 55892

TOOLS REQUIRED:

- 2 - 7/16" Wrenches
- 2 - 1/2" Wrenches
- 2 - 9/16" Wrenches

HARDWARE INCLUDED:

Item	Qty	Description
1	2	Saddles
2	4	5/16"-18 Ski Stop bolts
3	4	5/16" Lock nuts
4	4	5/16" x 1/2" Rubber Sleeve
6	4	1/4-20 Bolts
7	4	1/4" Flat Washers
8	4	1/4-20 Lock Nuts
9	4	Pivot spacers
10	-	Spindle mounting hole
11	2	3/8" bolt
12	2	3/8" washer
13	2	3/8" lock nut

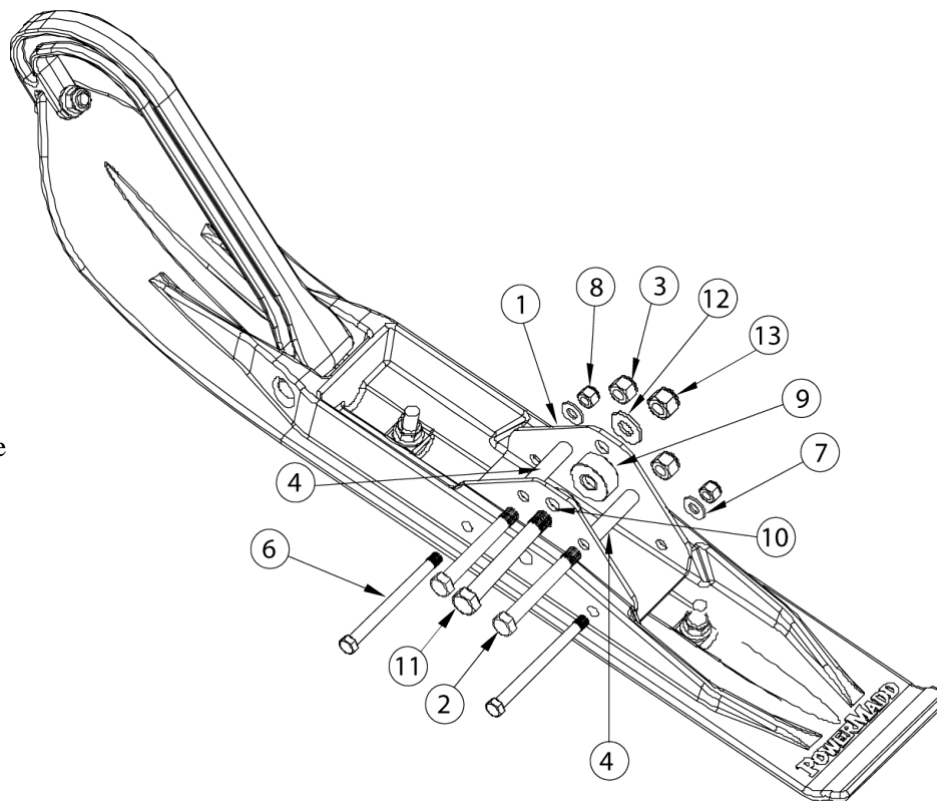

Step 1: Assemble the POWERMADD saddles (item 1) to the POWERMADD Mini-skis using the 1/4"-20 mounting hardware (items 6, 7 & 8) as shown in the illustration above. Do not over tighten.

Note – the saddle must face forward according to the illustration at the right, with the higher side hole towards the front of the ski.

Step 2: Install the ski-stop bolts and rubber sleeves in the ski saddle (item 1) as illustrated above. Insert the 5/16"-18 bolt into the front upper saddle holes; through the 5/16"x 1/2" rubber sleeve and then lock nut (items 2, 3 & 4). For the rear follow the same steps as above. Do not over tighten.

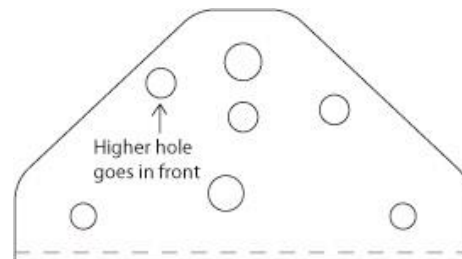

Step 3: Remove the stock skis and install the PowerMadd skis using the 3/8-16 bolt, 3/8 flat washer and 3/8 lock nut. Place a pivot spacer(item 9) on each side of the spindle. Do not over tighten

Congratulations! We hope you thoroughly enjoy using your Plastic Mini-Ski.

LIMITED WARRANTY

POWERMADD warrants this product to be free from defects in material and workmanship under use for the purpose it was intended. POWERMADD shall not be liable for damage or injury caused by defective materials or workmanship. POWERMADD may elect to repair or replace this product, but is the sole judge of any defects in their product. This warranty does not cover any labor costs to remove or reinstall this product and is effective for one year from the original purchase date.

POWERMADD®

651-462-8465

www.powermadd.com

M 55890